

AIR CONDITIONER (SPLIT TYPE)

REMOTE CONTROLLER ILLUSTRATION



Cassette, Duct

SINCCLAIR

Thank you very much for purchasing our air conditioner.
Please read this owner's manual carefully before using
your air conditioner.

EXAMPLE OF TIMER SETTING

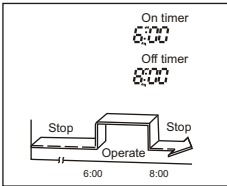

On timer → OFF timer
(Stop → Operation → Stop)
You can use this setting to start the air conditioner when you wake up and stop it when you leave the house.

- Example:
To start the air conditioner at 6:00 nest morning, and stop it at 8:00.
1. Push the **TIMER ON** button.
 2. Use the **TIME ADJUST** button to display "6:00" on the **ON** timer indicator of the remote controller.
 3. Push the **TIMER OFF** button.
 4. Use the **TIME ADJUST** button to display "8:00" on the **OFF** timer indicator.
 5. Push the **OK** button.
- The timer function (**ON** or **OFF**) which in time is closest to the actual time will be activated first.
 - If the same time is set for both **ON** and **OFF** timers, no timer operation is performed. Also, the air conditioner may stop operating.

ADJUSTING AIR FLOW DIRECTION

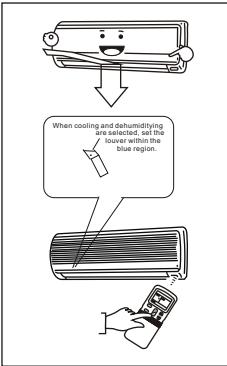

- Adjust the air flow direction properly. Otherwise it might cause discomfort and make the room temperature uneven.
- Adjust the vertical air flow louver using the remote controller.
- Adjust the horizontal air flow grilles manually.

Adjusting the Vertical Air Flow Direction

The air conditioner automatically adjust the vertical air flow direction in accordance with the operating conditions.

To set the air flow direction you desire

Perform this function while the unit is in operation. Keep pushing the **AIR DIRECTION** button on the remote controller to move the louver to the desired direction.

- Change the vertical air flow louver direction within the range indicated.
- In subsequent operations, the vertical air flow is automatically set in the direction to which you adjusted the louver pushing the **AIR DIRECTION** button.

REMOTE CONTROLS AND THEIR FUNCTIONS	1
NAMES AND FUNCTIONS OF INDICATORS ON REMOTE CONTROLLER	3
HANDLING THE REMOTE CONTROLLER	4
SETTING THE CLOCK	5
LOCK AND RESET BUTTON FUNCTION	6
AUTOMATIC OPERATION	7
COOLING/FAN ONLY OPERATION	8
DRYING OPERATION	8
TIMER OPERATION	9
EXAMPLE OF TIMER SETTING	10
ADJUSTING AIR FLOW DIRECTION	11

REMOTE CONTROLS AND THEIR FUNCTIONS

Mode select button

Each time you push the button, a mode is selected in a sequence that goes from AUTO, COOL, DRY, HEAT (cooling only type with-out), FAN ONLY and back to AUTO.

Fan speed button

This button is used for selecting fan speed. Each time you push the button, a fan speed is selected in a sequence that goes from AUTO, LOW, MED, HIGH, and back to AUTO.

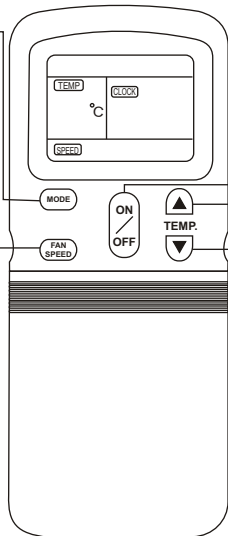

ON/OFF button

Push the button to start operation, push the button again to stop operation.

Temperature button

- ▲: The set temperature is increased to 30C
- ▼: The set temperature is decreased to 17C

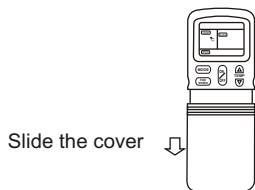

EXAMPLE OF TIMER SETTING

OFF timer

(Operation → Stop)

The OFF timer feature is useful when you go to sleep. The air conditioner will stop automatically at the time set.

Example:

To stop the air conditioner at 23:00 p.m.

1. Push the **TIMER OFF** button.
2. Use the **TIME ADJUST** button to display "23:00" on the OFF timer indicator.
3. Push the **OK** button.

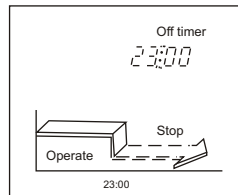

ON timer

(Stop → Operation)

The ON timer feature is useful when you wake up in the morning or when you return home. The air conditioner will automatically start operating at the time set.

Example:

To start the air conditioner at 6:00.

1. Push the **TIMER ON** button.
2. Use the **TIME ADJUST** button to display "6:00" on the ON timer indicator of the remote controller.
3. Push the **OK** button.

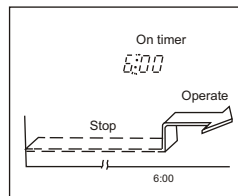

COMBINED TIMER (Setting both ON and OFF timers simultaneously)

OFF timer → ON timer

(Operation → Stop → Operation)

This feature is useful when you want to stop the air conditioner after you go to sleep, and start it again in the morning when you wake up or you return home.

Example:

To stop the air conditioner at 23:00 and start it again next morning at 6:00.

1. Push the **TIMER OFF** button.
2. Use the **TIME ADJUST** button to display "23:00" on the OFF timer indicator.
3. Push the **TIMER ON** button.
4. Use the **TIME ADJUST** button to display "6:00" on the ON timer indicator.
5. Push the **OK** button.

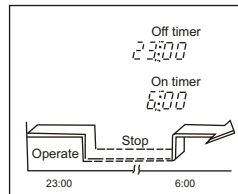

TIMER OPERATION

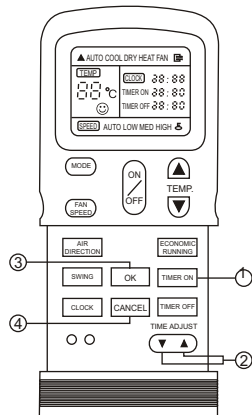

- ON / OFF TIMER button**
Push the ON or OFF TIMER button as required. The current timer setting is displayed along with ON/OFF TIMER indicator, and the colon in the timer setting will flash.
- Time adjust button (TIME ADJUST)**
Push to set the desired time.
 - ▲ Forward
 - ▼ Backward

Each time you push the button the time moves forward or backward by 10 minutes depending on which one you push. The time alters as quickly as you push the button..
- Reserve button (OK)**
Push this button. Check the TIMER lamp on the display panel of the indoor unit is lit.

Canceling

- Cancel button (CANCEL)**
Push the CANCEL button to cancel the timer setting.

Changing

Preform steps 1, 2 and 3 to change the setting.

CAUTIONS

- When you select the timer operation, the remote controller automatically transmits the timer signal to the indoor unit at the specified time. Therefore, keep the remote controller in a location from which it can transmit the signal to the indoor unit properly.
- The effective operation time set by remote controller is limited in 24 hours.

REMOTE CONTROLS AND THEIR FUNCTIONS

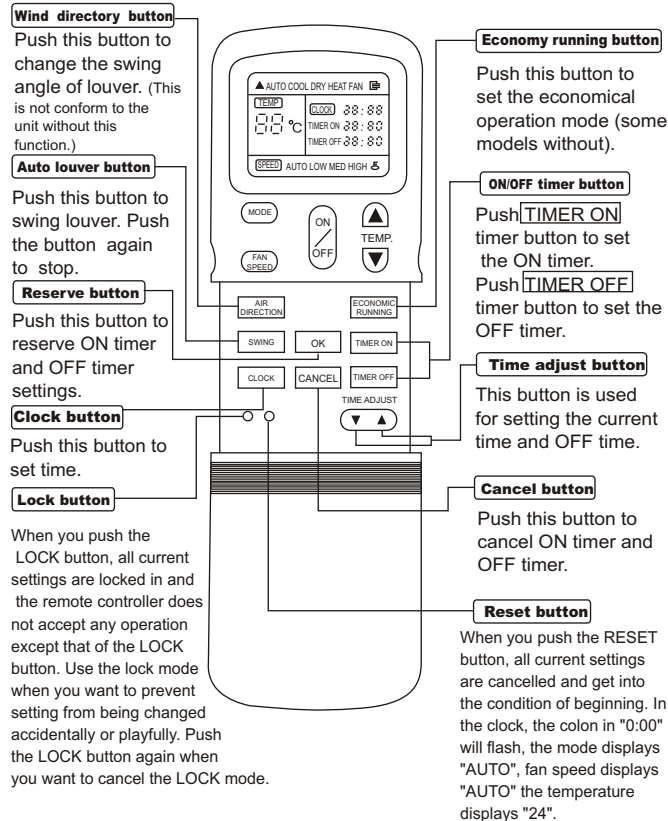

- The remote controller above drawing may have some differences from the one that you purchase.

NAMES AND FUNCTIONS OF INDICATORS ON REMOTE CONTROLLER

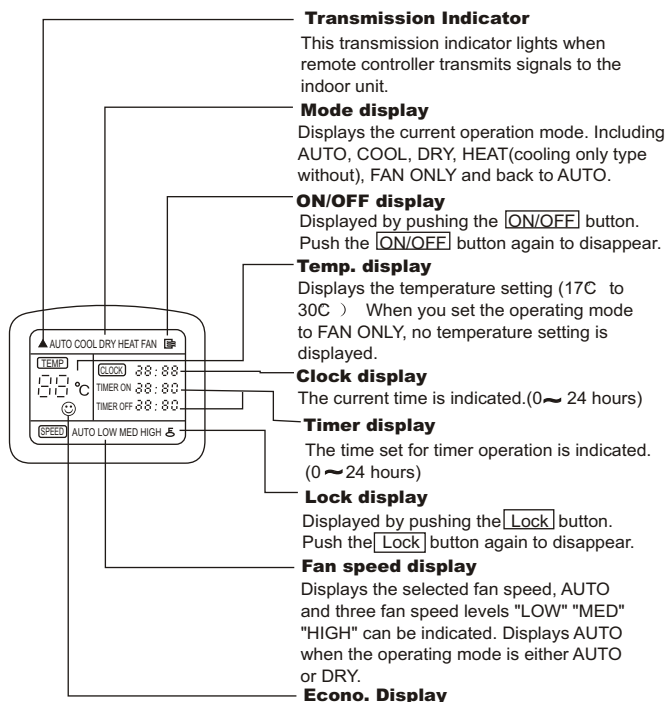

• In the illustration, all displays are indicated for the sake of clarity. During operation, only the relevant displays will be shown on the remote controller.

COOLING/FAN ONLY OPERATION

Start

Connect the unit with the power.

The OPERATION lamp on the display panel of the indoor unit starts flashing.

1. Mode select button (MODE)
Select COOL, HEAT (cooling only type without), or FAN ONLY
2. Temperature button (TEMP.)
Set the desired temperature.
Cooling 21C or higher
Heating 28C or lower
3. Fan speed button (FAN SPED)
Select any of the "AUTO" "LOW", "MED" and "HIGH"
4. ON/OFF button

Push this button to start the air conditioner.

The OPERATION lamp on the display panel of the indoor unit lights. The operating mode is selected in accordance with the room temperature and operation starts after approximately 3 minutes (If you select FAN ONLY mode, the unit will start immediately.)

Stop

ON/OFF button

Push this button again to stop the air conditioner.

The FAN ONLY mode does not control temperature.

Therefore, perform only steps 1, 3, and 4 to select this mode.

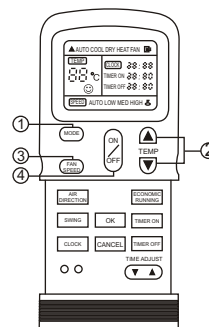

DRYING OPERATION

Start

Connect the unit with the power.

The OPERATION lamp on the display panel of the indoor unit starts flashing.

1. Mode select button (MODE)
Select DRY.
2. Temperature button (TEMP.)
Push the "TEMP." Button.
The fan speed indicator displays AUTO. The Indoor fan speed will be automatically selected LOW.
3. ON/OFF button
Push this button to start the air conditioner.
The OPERATION lamp on the display panel of the indoor unit lights, and operation starts after approximately 3 minutes.

Stop

ON/OFF button

Push this button again to stop the air conditioner.

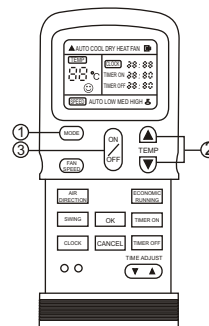

AUTOMATIC OPERATION

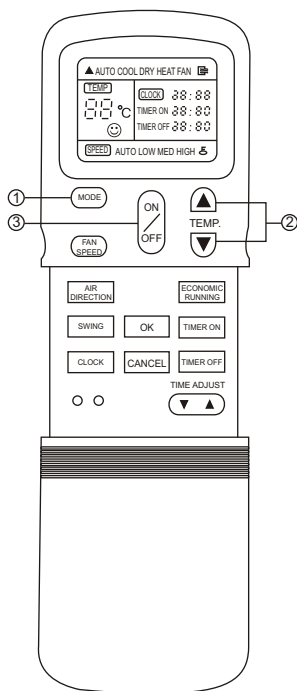

When you set the air conditioner in AUTO mode, it will automatically select cooling, heating (cooling only type without), or fan only operation depending on the room temperature.

Once you select the operating mode, the operating conditions are saved in the unit's microcomputer memory.

Thereafter, the air conditioner will start operating under the same conditions when you simply push the ON/OFF button of the remote controller.

Start

The OPERATION lamp on the display panel of the indoor unit starts flashing.

1. Mode select button (MODE)

Select AUTO.

2. Temperature button (TEMP.)

Set the desired temperature. Normally, set it between 21°C to 28°C

3. ON/OFF button

Push this button to start the air conditioner. The OPERATION lamp on the display panel of the indoor unit lights. The operating mode is selected in accordance with the room temperature and operation starts after approximately 3 minutes.

Stop

ON/OFF button

Push this button again to stop the air conditioner.

If the AUTO mode is uncomfortable, you can select the desired conditions manually. When you select the AUTO mode, you do not have to set the fan speed. The FAN speed display will show AUTO and the fan speed will be automatically controlled.

HANDLING THE REMOTE CONTROLLER

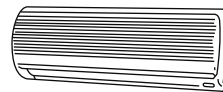

Location of the remote controller.

- Keep the remote controller where its signals can reach the receiver of the indoor unit. (a distance of 8m is allowed).
- When you select the timer operation, the remote controller automatically transmits a signal to the indoor unit at the specified time.

If you keep the remote controller in a position that hinders proper signal transmission, a time lag of up to 15 minutes may occur.

CAUTIONS

- The air conditioner will not operate if curtains, doors or other materials block the signals from the remote controller to the indoor unit.
- Prevent any liquid from falling into the remote controller. Do not expose the remote controller to direct sunlight or heat.
- If the infrared signal receiver on the indoor unit is exposed to direct sunlight, the air conditioner may not function properly. Use curtains to prevent the sunlight from falling on the receiver.
- If other electrical appliances react to the remote controller, either move these appliances or consult your local dealer.

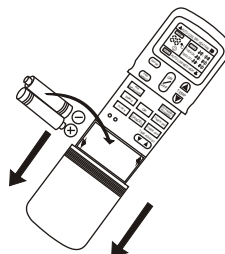

Replacing batteries

The remote controller uses two alkaline dry batteries (R03/LR03X2)

- (1) Slide the cover of the battery compartment, then replace the old batteries with new ones.
 - (2) After step (1) is done, push the RESET button.
 - (3) Before replacing the battery compartment cover, confirm that the display screen on the remote controller displays "0:00" and that the colon is flashing.
- After replacing batteries, set the remote controller clock.

NOTES

- When replacing batteries, do not use old batteries or different type batteries. Otherwise it may cause the remote controller to malfunction.
- If you do not use the remote controller for a few weeks or more, remove the batteries. Otherwise, battery leakage may damage the remote controller.
- The average battery life during normal use is approximately half a year. Replace the batteries when there is no receiving beep from the indoor unit or if the transmission indicator on the remote controller fails to light.

SETTING THE CLOCK

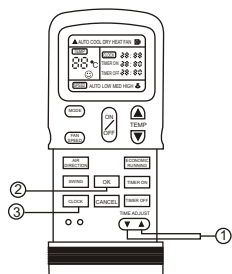

Before you start operating the air conditioner, set the clock of the remote controller using the procedures given in this section. The clock panel on the remote controller will display the time regardless of whether the air conditioner is in use or not.

Initial Setting or the Clock

When batteries are inserted in the remote controller, the clock panel will display "0:00" and the colon will flash.

1. Time adjust button (TIME ADJUST)

- Push this button to set time.

▲ Forward.

▼ Backward.

- Each time you push the button, the time moves forward or backward by one minute depending on which side you Push. The time alters as quickly as you push the button..

Clock
11:11

2.OK button.

- When you push the OK button, the clock time display stops flashing and the clock starts operating.

3.Readjusting the Clock

- Push the CLOCK button in the battery compartment, the colon in the clock display will start to flash.

To set the new time, follow 1 and 2 of "Initial Setting of the Clock".

* Clock accuracy is within 10 seconds per day.

CAUTIONS

Static electricity or other factors (in case of extremely high voltage) can cause remote controller clock initialize. If your remote controller is initialized (flashing of the colon in "0:00"), readjust the clock before you start operation.

LOCK AND RESET BUTTON FUNCTION

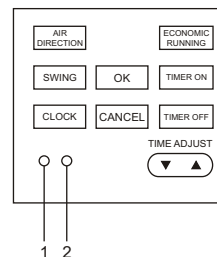

- When you push the LOCK button, all current settings are locked in and the remote controller does not accept any operation except that of the LOCK button. Use the lock mode when you want to prevent settings from being changed accidentally or playfully. Push the LOCK button again when you want to cancel the LOCK mode.
- When you push the RESET button, all current settings are cancelled and get into the condition of beginning. In the clock, the colon in "0:00" will flash, the mode displays "Auto", the fan speed displays "Auto", the temperature displays "24".

ADJUSTING AIR FLOW DIRECTION

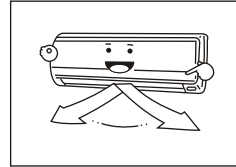
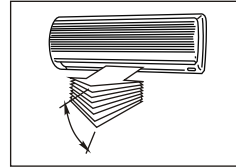

To automatically swing the air flow direction Perform this function while the air conditioner is in operation. Push the **SWING** button on the remote controller.

- To stop the function, push the **SWING** button again.
- To change the swing direction, push the **AIR DIRECTION** button.

CAUTIONS

- The **AIR DIRECTION** and **SWING** buttons will be disabled when the air conditioner is not in operation (including when the **ON TIMER** is set).
- Do not operate the air conditioner for long hours with the air flow direction set downward during the cooling or dry operation. Otherwise, condensation may occur on the surface of the vertical air flow louver and cause dew dripping.
- Do not move the vertical louver manually. Always use the **AIR DIRECTION** button. If you move the louver manually, it may malfunction during operation. If the louver malfunctions, stop the air conditioner once and restart it.
- When the air conditioner is started immediately after it was stopped, the vertical air flow louver might not move for 10 seconds or so.